

T W O T H O U S A N D T H R E E

Tradewinds LTC



Luxury Touring Class.



THE ESSENCE OF LUXURY



▲ TLTC 7391 COCKPIT AREA IN MOCHA SUNSET



Only Tradewinds LTC provides a level of style, comfort and sophistication worthy of the Luxury Touring Class marque. From the beautifully designed interior decors featuring opulently milled fabrics and an array of rich fine-grained hardwoods, to the monogrammed Ultraleather™ seating, Tradewinds LTC is a coach like no other.

A cutting-edge entertainment center

features a variety of devices for enjoying broadcast, satellite or recorded music, movies or television.

Lustrous Corian® solid surface countertops are used liberally throughout the coach, while designer hand-laid ceramic tile and color-coordinated patterned carpets extend the LTC's styling to the floor beneath you.

A variety of spacious floorplans feature double roadside slide-outs for maximum livability. LTC's Huge



▲ TLTC 7391 WONDER BED

angled galley are the delight of the most discerning chefs. And the standard 10 cu. ft. or optional 12 cu. ft. refrigerator with icemaker will keep those chefs well-stocked!

The master bedroom suite includes an open bathroom design that creates a living space of palatial proportions. Double pocket doors provide privacy when needed. Tradewinds LTC's exclusive "Beachcomber Premium" pillow-top queen mattress is literally the stuff that dreams are made of.

The guiding principles of the Tradewinds LTC are the definition of luxury itself: maximum comfort and style without compromise.



▲ TLTC 7391 GALLEY IN MAPLE



▲ TLTC 7391 OPTIONAL EURO RECLINER AND OTTOMAN



▲ TLTC 7391 WARDROBE IN MOCHA SUNSET

WIDE OPEN SPACES

FREEDOM OF CHOICE



▲ TLTC 7374 LIVING AREA IN PLATINUM SANDS (WITH OPTIONAL EURO RECLINER)



▲ TLTC 7374 BEDROOM IN PLATINUM SANDS



▲ TLTC 7391 BEDROOM IN MOCHA SUNSET



NATIONAL RV™

CHOOSE YOUR COLOR:

Every Tradewinds LTC receives a meticulous application of full-body paint using a multi-stage process in National RV's state-of-the-art paint facilities. Only premium automotive finishes are used, assuring a smooth, lustrous finish that will make your Tradewinds LTC the envy of the highways. Choose from three beautiful color schemes.



▲ TRADEWINDS LTC IN MOCHA SUNSET



▲ TRADEWINDS LTC IN PLATINUM SANDS



▲ TRADEWINDS LE IN TROPICAL ELEGANCE

Personalize your Tradewinds LTC with your choice of three rich interior decors. Complement the decor with your choice of genuine hardwood cabinetry.

RICH INTERIOR FABRICS

▼ MOCHA SUNSET



▼ PLATINUM SANDS



▼ TROPICAL ELEGANCE



GENUINE HARDWOOD CABINETRY

▼ MAPLE



▼ WALNUT



▼ CHERRY



BEST BUILT...

The entire coach body— floor, sidewalls, roof—is constructed of a rugged tubular steel framework, high density foam insulation and the highest quality interior and exterior surfaces. Each component is vacuum-bonded to form a solid, rigid structure.

Every coach component is manufactured with the latest processes and the strictest quality standards. After nearly 40

years of building some of America's favorite recreational vehicles, ***we know how to do it right!***

...BEST BACKED.

Peace of Mind is standard equipment with all National RV motorhomes. Our **3-years/ unlimited miles warranty** against structural defects to the coach body and

subfloor structure leads the industry. Our professional Owner Services staff, extensive dealer network and factory service centers on both coasts stand ready to assist with any warranty issues. And we back you on the road against any unforeseen

problems with full-featured **Coach Net®** emergency roadside assistance, service scheduling assistance and a host of extra travel benefits, free to you for your first year of owning your new National RV motorhome.

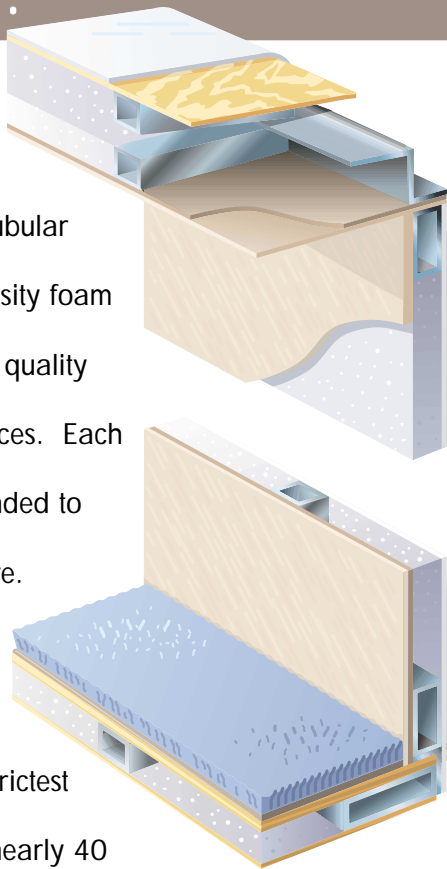

A DRIVER'S COACH

LTC is built on the idea that getting there is half the fun. That's why every aspect of the chassis, suspension and drivetrain are designed to make *driving* the LTC a rewarding experience.



Perhaps the most important part of pleasurable driving is enjoying power on demand. This is provided by the formidable Cummins® ISC electronic diesel engine, which flattens mountains with 370 horsepower and a whopping 1,050 lbs.-ft. of torque.

On-road handling is unsurpassed due to Tradewinds LTC's Neway® independent front suspension. IFS allows each wheel to absorb the irregularities of the road without heavily affecting the rest of the coach. The result is better, safer handling and a smoother, more stable ride.



See your nearest National RV dealer to experience the pleasure of driving the Luxury Touring Class.



YOUR ISLAND OF STEEL

DURAFRAME® & UNI-CAGE®

Every National RV gasoline motorhome is built with patented Duraframe® technology. This patented all-steel truss-frame design imparts brute strength to the chassis to help it resist the forces of



traveling, thereby relieving stresses from the sidewalls and other coach body components. This results in less squeaks and rattles and longer lasting structural integrity. Duraframe® also makes it possible to enjoy large, diesel-style pass-through basement storage bays.

National RV's vacuum bonded sidewalls, roof and floor—the coach "body"—is the culmination of nearly 40 years of engineering for strength and durability. On every National RV, a welded tubular steel framework runs through all of the coach body components, enveloping the coach in a sturdy cage of steel—the Uni-Cage®.

The strengths of the Duraframe® and Uni-Cage® are combined to form one of the most durable motorhomes on the road: Tradewinds LTC.

YOUR AUTHORIZED TRADEWINDS LTC DEALER IS:

NATIONAL R.V., INC.

3411 N. Perris Boulevard
Perris, California 92571
(909) 943-6007 - Fax (909) 943-8498

www.nationalrv.com

© 2002 National R.V., Inc. Due to continuing product improvements, colors, specifications and equipment are subject to change without notice.

2003 INFORMATION SHEET

TRADEWINDS LTC 7374

Tradewinds LTC

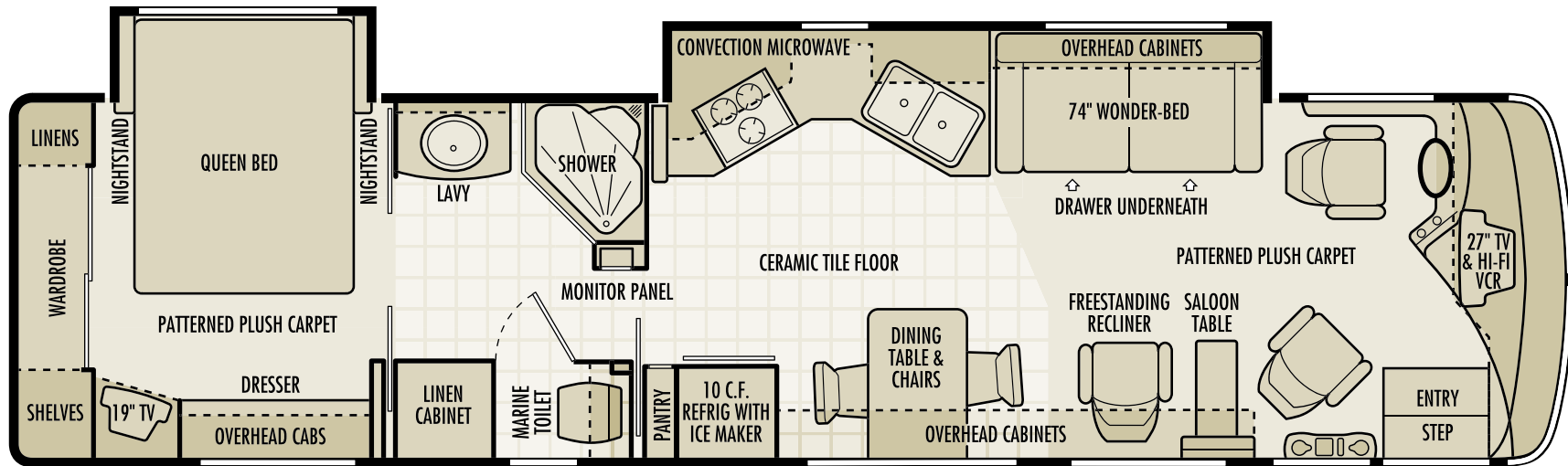

OPA #1112



OPA #288

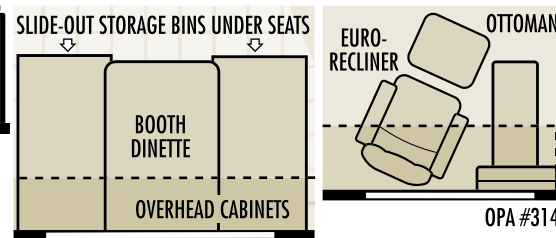

OPA #3218

OPA #3147

WEIGHT RATINGS (Pounds)

Gross Vehicle Weight Rating	29,410
Gross Combined Weight Rating	36,410
Front Gross Axle Weight Rating	10,410
Rear Gross Axle Weight Rating	19,000
Unloaded Vehicle Weight	TBD
Maximum Carrying Capacity	TBD
Cargo Carrying Capacity	TBD

MEASUREMENTS

Wheelbase	228"
Overall Length	36' 9"
Overall Height (w/satellite dome)	12' 6"
Interior Height	79 1/2"
Interior Width	98 1/2"
Exterior Width	102"

TANK CAPACITIES (Gallons)

Fuel (diesel)	100
Fresh Water Tank	95
Grey Tank	40
Black Tank	45
Water Heater	10
LPG Tank (volume)	69

CHASSIS

Make/Model	Freightliner X-C Series
Design	Rear Engine/Raised Rail
Axle Ratio	4.88:1
Tires	255/80R22.5 (G)
Service Brakes	Full Air/Drums with ABS
Shocks	Tuned Bilstein
Alternator	160 Amp Leece-Neville
Warranty	3 Years/50,000 Miles

ENGINE

Make/Model	Cummins ISC
Displacement	8.3 Liters
Peak HP	350 HP @ 2,000 RPM
Peak Torque	1,050 ft./lbs @ 1,400
Exhaust Brake	Pac Brake
Warranty	5 Years/100,000 Miles

TRANSMISSION

Make/Model	Allison MH 3000
Type	6-Speed Automatic w/OD
Shifter	Electronic keypad
Warranty	3 Years/Unlimited Miles



NOTE: Floorplans and features are subject to change without notice.
 © Copyright 03/2002 National R.V., Inc., 3411 N. Perris Boulevard, Perris, CA 92571 •

TLTC 7374

2003 INFORMATION SHEET

TRADEWINDS LTC 7391

Tradewinds LTC



TWO THOUSAND **3**

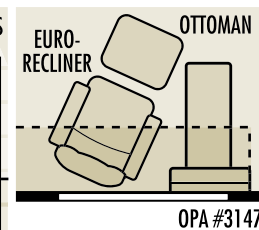
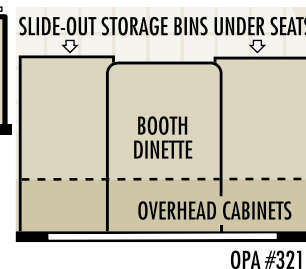
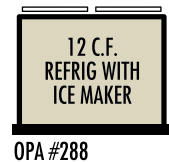
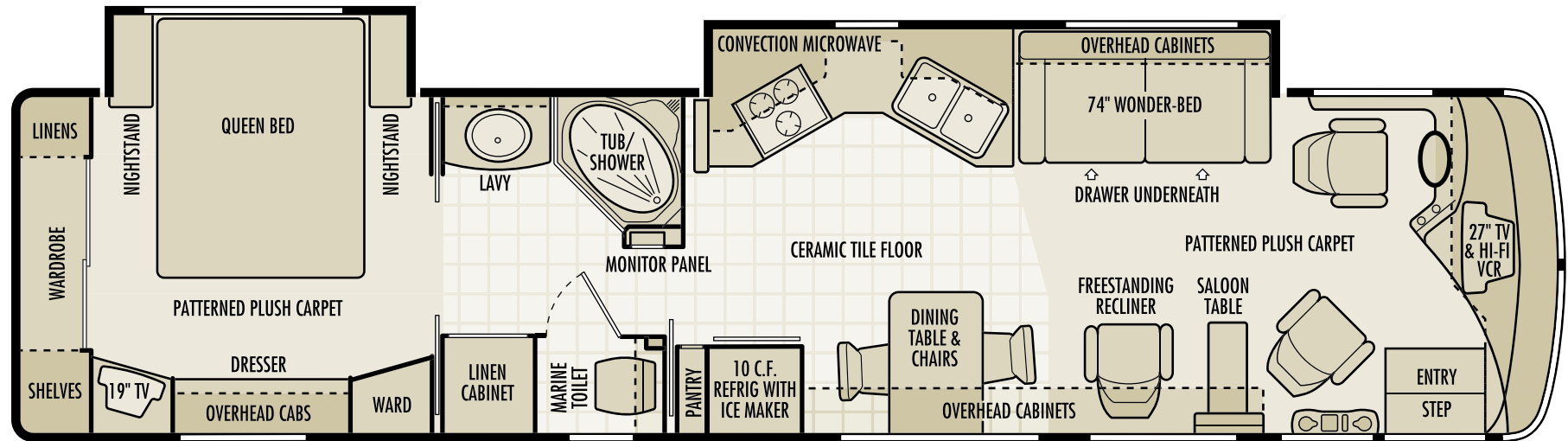

WEIGHT RATINGS (Pounds)

Gross Vehicle Weight Rating	29,410
Gross Combined Weight Rating	36,410
Front Gross Axle Weight Rating	10,410
Rear Gross Axle Weight Rating	19,000
Unloaded Vehicle Weight	24,180
Maximum Carrying Capacity	5,230
Cargo Carrying Capacity	3,494

MEASUREMENTS

Wheelbase	252"
Overall Length	38' 9"
Overall Height (w/satellite dome)	12' 6"
Interior Height	79 1/2"
Interior Width	98 1/2"
Exterior Width	102"

TANK CAPACITIES (Gallons)

Fuel (diesel)	100
Fresh Water Tank	95
Grey Tank	40
Black Tank	45
Water Heater	10
LPG Tank (volume)	69

CHASSIS

Make/Model	Freightliner X-C Series
Design	Rear Engine/Raised Rail
Axle Ratio	4.88:1
Tires	255/80R22.5 (G)
Service Brakes	Full Air/Drums with ABS
Shocks	Tuned Bilstein
Alternator	160 Amp Leece-Neville
Warranty	3 Years/50,000 Miles

ENGINE

Make/Model	Cummins ISC
Displacement	8.3 Liters
Peak HP	350 HP @ 2,000 RPM
Peak Torque	1,050 ft./lbs @ 1,400
Exhaust Brake	Pac Brake
Warranty	5 Years/100,000 Miles

TRANSMISSION

Make/Model	Allison MH 3000
Type	6-Speed Automatic w/OD
Shifter	Electronic keypad
Warranty	3 Years/Unlimited Miles



NOTE: Floorplans and features are subject to change without notice.
 © Copyright 03/2002 National R.V., Inc., 3411 N. Perris Boulevard, Perris, CA 92571 •

TLTC 7391

Tradewinds LTC

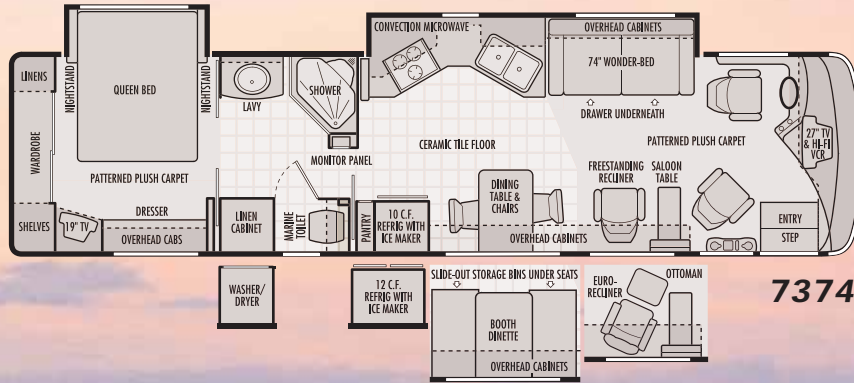

7374

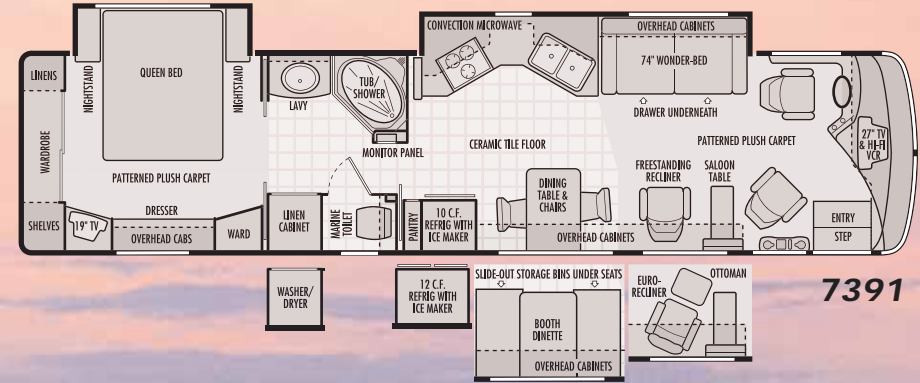

7391

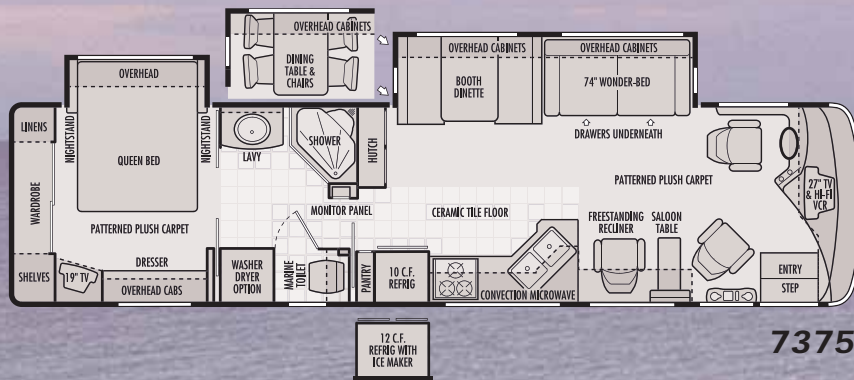

7375

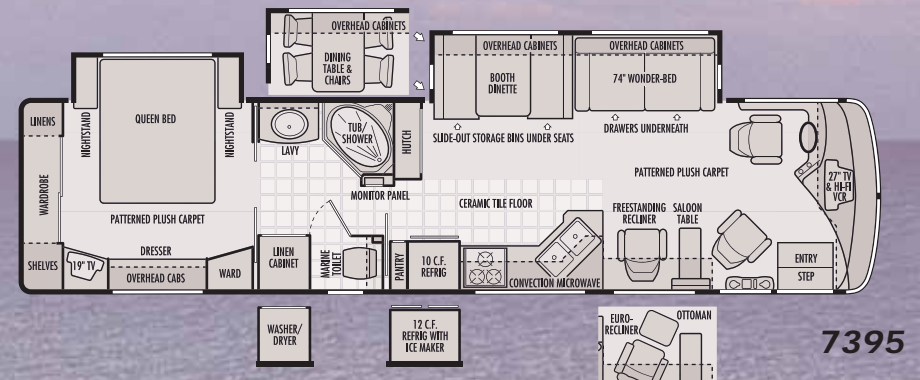

7395



CHASSIS SPECIFICATIONS	DYNAMAX
Chassis	Country Coach Dynamax®
Chassis Design	Dynomax® 8TD ⁴ tube frame chassis system by Country Coach
Steering Gear	TRW TAS 85 integral hydraulic power steering gear with 95° possible turning angle and 23.5:1 steering ratio
Tires	Steel belted radial tires Toyo® 275R x 22.5 (H)
Wheels	Four 8¼" x 22½" aluminum alloy wheels; two inner dual steel wheels; 10 lug
Service Brakes	Full air brakes with ABS; 16.5" x 7" drums (rear) s-cam style, automatic slack adjusters

Parking Brake	Spring applied, air release on rear drum brakes
Alternator	Leece-Neville® 160 Amp alternator
Chassis Batteries	Group 8 battery with slide-out tray 1,000 CCA engine (4) each 240AH house batteries Manual chassis battery disconnect
Front Suspension	Neway® independent front suspension
Rear Suspension	Neway® AD-200 20,000 lb. capacity
Spring Type	Neway® full air suspension system with electric air dump
Shock Absorbers	Koni® model 88
Driveline	Dana Spicer® 1710 series
Drive Axle	Meritor® RS-21-145
Drive Axle Ratio	4.63:1
Fuel Capacity	110 gallon fuel tank; Fleetguard® fuel/water separator

Engine Block Heater	120V 1,000 watt engine block heater
Cooling Pack Mounting	Side mounted
Charge Air Cooler	Cross flow
Transmission Oil Cooler	Remote mounted; water to oil
Cooling Fan	Variable speed hydraulic
Air Intake Restriction Indicator	Filter Minder®
Other features	Curbside access to service center
Fueling	Fuel/water separator remote mounted in utility compartment
Towing Equipment	10,000 lb. Class III hitch receiver with skid bar and six-pin electrical connector
Chassis Warranty	2 years/unlimited miles
Engine	Cummins® ISC
Displacement	8.3L
Peak Horsepower	350 HP @ 2,000 RPM

Peak Torque	1,050 lb/ft torque @ 1,400 RPM
Engine/Exhaust Brake	Cummins® extarder exhaust brake
Engine Warranty	5 year/100,000 miles
Transmission	Allison® MH 3000
Transmission Type	Six speed automatic with 2 overdrive gears
Gear ratios	3.49:1 First gear 1.86:1 Second gear 1.41:1 Third gear 1.00:1 Fourth gear 0.75:1 Fifth gear 0.65:1 Sixth gear -5.03:1 Reverse
Transmission Shifter	Keypad electronic shifter with digital display
Transmission Warranty	3 years/unlimited miles

Due to continued product improvement, National R. V., Inc. reserves the right to change materials, colors, specifications and prices at any time without notification. Copyright © 2002 by National R. V., Inc. 07/02



TRADEWINDS LTC FEATURES & SPECIFICATIONS

BODY CONSTRUCTION

Duraframe® patented steel sub floor construction
Steel framed laminated floor
Steel framed crowned laminated fiberglass roof
Steel framed laminated fiberglass high gloss walls
Custom painted three color full body exterior graphics with choice of three color packages
Molded, high gloss, full fiberglass caps with integrated front and rear bumpers
Soft touch interior ceiling material
Electric slide-out rooms
Fiberglass exterior storage compartment doors, insulated with integrated paddle latches and struts
Aluminum rear ladder
Convenience D-Ring mounts in basement storage compartments
Automotive undercoating as required
Steel insulated front bulkhead

COCKPIT FEATURES

Pioneer® AM/FM stereo with CD player, XM™ receiver and remote control
Driver and passenger gooseneck reading lights
Custom dash in high gloss walnut finish with full gauge package
Cockpit heater and air conditioner with dash controls
Convenience tray
Auxiliary driving lights
Pantographic windshield wipers
Power steering
Electronic cruise control
18" tilt and telescopic steering wheel
Roof mounted dual chrome trumpet air horns
Rear vision system with microphone
Painted to match power controlled heated exterior mirrors with power convex control
Power Gear® fully automatic leveling jacks
Passenger workstation with 12V receptacle and 110V receptacle
Aviation style sun visors
Cup holders
Two 2-speed dash fans
Electric stepwell cover
CB radio ready
Wraparound privacy curtain with easy reach wand

APPLIANCES & ACCESSORIES

RCA® 27" TV with front A/V jacks in cockpit
RCA® Hi-Fi VCR in cockpit
Multi-speaker TV sound
RCA® 19" TV with front A/V jacks in bedroom
10 cu. ft. double door refrigerator with icemaker and pantry
High output three burner cook top with flush mount Corian® range cover
GE® SpaceSaver convection microwave oven with carousel, built-in light and fan
Systems monitor panel
Cable TV hook-up and multiple telephone jacks
Wall mounted AM/FM stereo with CD, clock, alarm and inside temperature monitor in bedroom

Kingdome® automatic stationary satellite dish
Winegard® TV antenna

FURNITURE

Kustom Fit® monogrammed UltraLeather™ 6-way power driver recliner seat with swivel base and integrated seatbelt
Kustom Fit® monogrammed UltraLeather™ passenger recliner seat with swivel base and integrated seatbelt
Kustom Fit® 74" Wonder-Bed™ fabric sleeper sofa with slide-in armrests and drawer underneath
Freestanding Kustom Fit® fabric swivel recliner chair with footrest

INTERIORS

Throughout Coach

Maple paneling and doors
Solid wood raised panel cabinet doors and face framing
Deluxe overhead storage doors with telescruit hardware; positive catches on all other doors

Drawers with ball bearing roller guide design

Cockpit Area

Patterned floor mats

Living Area

Fabrica® patterned plush carpet with deluxe pad
Pleated day/night shades
Valances and lambrequins
Magazine rack
Freestanding Corian® topped dinette table with two high-back wooden chairs and two wooden folding chairs

Kitchen Area

Corian® kitchen countertop with Corian® sink cover
Corian® surface countertop extension (lounge slides only)
Wastebasket
Silverware organizer
Beveled mirror galley backsplash
Ceramic tile floor
Venetian blind and valance

Bath Area

Ceramic tile floor
Corian® surface bathroom lavatory
Porcelain oval lavatory sink
Raised panel doors
Insulated skylight in shower
Towel bars
Medicine cabinet
Window in private toilet room
Residential style pocket doors
Residential toilet room door with hardware

Bedroom Area

Fabrica® patterned plush carpet with deluxe pad
Pleated day/night shades
Valances and lambrequins
Raised panel doors
"Beachcomber Premium" residential-style pillow top mattress
Queen bed slide-out
Coordinate bedspread, pillows and shams

Radius padded headboard
Nightstands with Corian® tops
Cedar lining in wardrobe
Rear wardrobe with mirrored sliding doors
Wall dresser with drawers and laundry hamper
Residential style closet rods

ELECTRICAL SYSTEMS & LIGHTS

50 Amp 120V distribution panel and cord
50 Amp shore power cord
Dual 21 watt solar panels
Onan® 6.5 kW LP generator
2,000 watt inverter/converter with remote on/off switch
Four 6V deep cycle house batteries
Slide-out battery tray
Two 760 CCA 12V maintenance-free chassis batteries
Battery disconnect switch
Porch light
Patio receptacle
Three water pump switches (kitchen, bath and service station)
Decorative overhead dining light
Cosmetic light in bathroom
Decorative lights in living area
Courtesy light at entry-door switch panel
Fluorescent lights in ceiling
Decorative indirect mood lights

PLUMBING & LPG SYSTEMS

Coach Exterior

Heated and insulated holding and water tanks
Manual dump valves
Pressurized water fill with regulator
Variable rate water pump
Water heater by-pass valve
Winterization antifreeze inlet to pump
Holding tank rinsing system (waste only)
Outside shower

Kitchen Area

Water filter in kitchen
10 gallon gas/electric water heater
Delta® single lever faucet with pullout sprayer

Bedroom/Bathroom Area

Porcelain toilet with sprayer
Clear glass shower enclosure with etched decorative design for privacy
One piece fiberglass tub and shower
Single lever brass faucet with crystal handle
Pre-plumbed for washer/dryer

SAFETY FEATURES

Fire extinguisher
Deadbolt lock on entrance door
12V GFI protected circuits (kitchen, bath and exterior)
Smoke, carbon monoxide (CO) and LPG detectors
Driver and passenger integrated three point lap and shoulder seatbelts
Egress window
Deluxe acrylic exterior assist handle

WINDOWS, DOORS & AWNINGS

Tinted dual pane windows
Power double entrance step with light and anti-skid
Tinted skylight in bathroom
Electric patio awning with metal cover*
Electric front entry door awning*
Slide-out topper awnings on living room, galley slide and bedroom slide*

VENTILATION

Dual 13,500 BTU Duo-Therm® low profile Penguin® air conditioners with in-ceiling ducting
35,000 BTU and 20,000 BTU furnaces
12V Fan-Tastic® Vent in bathroom
12V Fan-Tastic® Vent with wall thermostat and rain sensor in living area

OPTIONAL FEATURES

Exterior

Upgraded custom painted three color full body exterior graphics with choice of three color packages
Dual directional roll-out compartment storage tray
Manual living room and bedroom window awning package
Onan® 7.5 kW Quiet Diesel generator
Dual 13,500 BTU Duo-Therm® low profile Penguin® air conditioners with heat pumps, two-speed fans and in-ceiling ducting
Chrome power controlled heated exterior mirrors with power convex control

Throughout Coach

Walnut paneling and doors

Cherry paneling and doors

Cockpit Area

Pioneer® multi-disc CD changer
Douglas® tilt and telescoping steering column with 18" VIP® Smart Wheel
RCA® DVD with Dolby Digital 5.1 receiver and home theater speaker package

Furniture

Kustom Fit® monogrammed UltraLeather™ 6-way power passenger recliner seat with swivel base, integrated seatbelt and power footrest
Kustom Fit® monogrammed UltraLeather™ 6-way power extra-wide passenger recliner seat with swivel base, integrated seatbelt and power footrest
Kustom Fit® 74" UltraLeather™ Wonder-Bed® sleeper sofa with slide-in armrests and drawer underneath
Freestanding Kustom Fit® UltraLeather™ Euro-recliner with ottoman
Freestanding Kustom Fit® UltraLeather™ swivel recliner chair with footrest
Corian® topped booth dinette with slide-out storage drawers

Kitchen Area

GE Advantium™ oven/microwave
12 cu. ft. side-by-side refrigerator with ice maker (delete slide-out pantry)

Bedroom/Bathroom Area

Combination washer/dryer
Theford® electric porcelain toilet with sprayer

WEIGHTS (POUNDS)	7374	7375	7391	7395
Dynamax				
Gross Vehicle Weight Rating	32,800 lbs.	32,800 lbs.	32,800 lbs.	32,800 lbs.
Gross Combined Weight Rating	42,800 lbs.	42,800 lbs.	42,800 lbs.	42,800 lbs.
Front Gross Axle Weight Rating	12,800 lbs.	12,800 lbs.	12,800 lbs.	12,800 lbs.
Rear Gross Axle Weight Rating	20,000 lbs.	20,000 lbs.	20,000 lbs.	20,000 lbs.
Unloaded Vehicle Weight	25,580 lbs.	TBD	TBD	TBD
Maximum Carrying Capacity	7,220 lbs.	TBD	TBD	TBD
Cargo Carrying Capacity	5,579 lbs.	TBD	TBD	TBD
MEASUREMENTS				
Wheelbase	228"	228"	252"	252"
Overall Length	36' 8"	36' 8"	TBD	TBD
Exterior Height (Road Height)	12'	12'	TBD	TBD
Exterior Height (with Satellite)	12' 4"	12' 4"	TBD	TBD
Interior Height	79 1/2"	79 1/2"	79 1/2"	79 1/2"
Interior Width	98"	98"	98"	98"
Exterior Width	102"	102"	102"	102"
TANK CAPACITIES				
Water Heater	10 gal.	10 gal.	10 gal.	10 gal.
Gray Tank	40 gal.	40 gal.	40 gal.	40 gal.
Black Tank	45 gal.	45 gal.	45 gal.	45 gal.
Fresh Water Tank(s)	95 gal.	95 gal.	95 gal.	95 gal.
LPG Tank (Volume W.C.)	42.7 gal.	42.7 gal.	42.7 gal.	42.7 gal.

*Not available on CSA units

Tradewinds LE

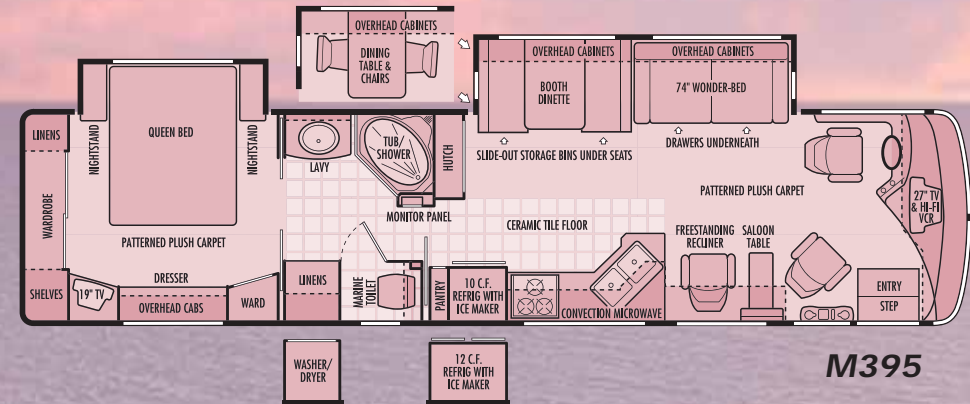
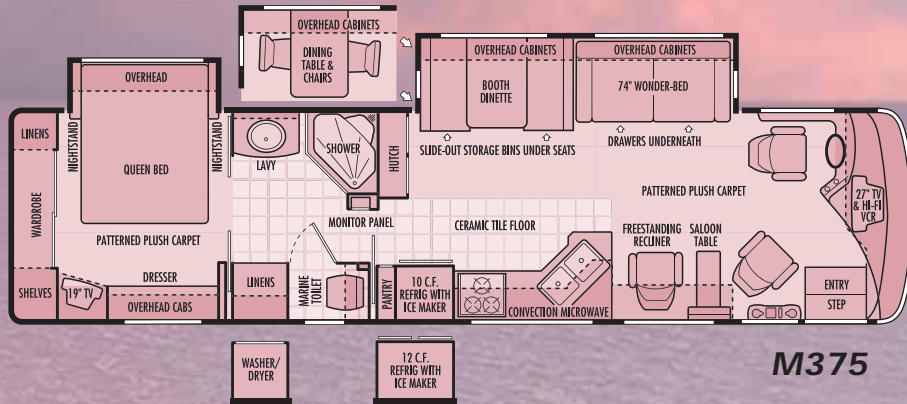
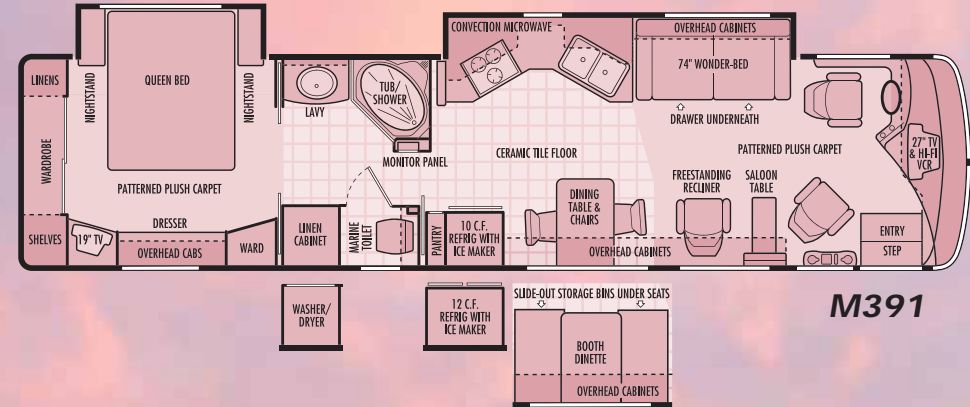
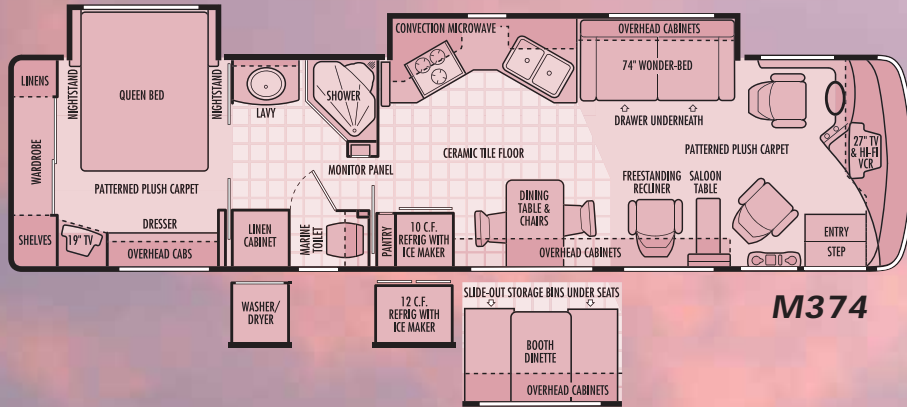

CHASSIS SPECIFICATIONS

	SPARTAN
Chassis	Spartan® Summit GTI (27,410 GVWR)
Chassis Design	Raised rail
Steering Gear	TRW TAS 55 power steering gear with 51° turning angle and 20.4:1 steering ratio
Tires	Michelin® radial tires 255/80R22.5(G)
Wheels	Steel wheels with stainless steel wheel simulators and valve extensions; 10 lugs
Service Brakes	Full air brakes with ABS; 15" x 4" front drums; 16.5" x 6" rear drums
Parking Brake	Spring applied, air release on rear drum brakes
Alternator	Leece-Neville® 160 Amp alternator
Chassis Batteries	Two BCI group 31 1,000 CCA

Front Suspension	Tuthill® independent front suspension
Rear Suspension	Reyco® 610AR 17,000 lb. capacity
Spring Type	Full air ride with dual ride height control valves and electronic manual air dump
Shock Absorbers	Tune Bilstein®
Driveline	Dana® Spicer 1610 series
Drive Axle	Meritor® RS-19-145
Drive Axle Ratio	4.88:1
Fuel Capacity	100 gallon fuel tank
Engine Block Heater	120V 1,000 watt engine block heater
Cooling Pack Mounting	Rear mounted
Charge Air Cooler	Cross flow
Transmission Oil Cooler	Integral to radiator; water to oil

Cooling Fan	Belt driven
Air Intake Restriction Indicator	Air intake restriction indicator
Other features	Frame mounted fuel/water separator
Towing Equipment	7,000 lb. Class III hitch receiver with skid bar and six-pin electrical connector
Chassis Warranty	2 years/50,000 miles
Engine	Caterpillar® 3126B
Displacement	7.2L
Peak Horsepower	330 HP @ 2,200 RPM
Peak Torque	860 lb/ft torque @ 1,440 RPM
Engine/Exhaust Brake	Pac Brake® exhaust brake
Engine Warranty	5 years/unlimited miles

Transmission	Allison® MH 3000
Transmission Type	Six speed automatic with 2 overdrive gears
Gear ratios	3.49:1 First gear 1.86:1 Second gear 1.41:1 Third gear 1.00:1 Fourth gear 0.75:1 Fifth gear 0.65:1 Sixth gear -5.03:1 Reverse
Transmission Shifter	T-handle electronic shifter with digital display
Transmission Warranty	3 years/unlimited miles



TRADEWINDS LE FEATURES & SPECIFICATIONS

BODY CONSTRUCTION

Duraframe® patented steel sub floor construction
 Steel framed laminated floor
 Steel framed crowned laminated fiberglass roof
 Steel framed laminated fiberglass high gloss walls
 Custom painted two color exterior graphics with choice of two color packages
 Molded, high gloss, full fiberglass caps with integrated front and rear bumpers
 Soft touch interior ceiling material
 Electric slide-out rooms
 Fiberglass exterior storage compartment doors, insulated with integrated paddle latches and struts
 Aluminum rear ladder
 Convenience D-Ring mounts in basement storage compartments
 Automotive undercoating as required
 Steel insulated front bulkhead

COCKPIT FEATURES

Pioneer® AM/FM stereo with CD player, XM™ receiver and remote control
 Driver and passenger gooseneck reading lights
 Custom dash in dark gray matte grid finish with full gauge package
 Cockpit heater and air conditioner with dash controls
 Convenience tray
 Pantographic windshield wipers
 Power steering
 Electronic cruise control
 18" tilt and telescopic steering wheel
 Rear vision system with microphone
 White power controlled heated exterior mirrors
 Hydraulic leveling jacks with dash mounted controls
 Passenger workstation with 12V receptacle and 110V receptacle
 Aviation style sun visors
 Cup holders
 Two 2-speed dash fans
 Electric stepwell cover
 CB radio ready
 Wraparound privacy curtain with easy reach wand

APPLIANCES & ACCESSORIES

RCA® 27" TV with front A/V jacks in cockpit
 RCA® Hi-Fi VCR in cockpit
 Multi-speaker TV sound
 RCA® 19" TV with front A/V jacks in bedroom
 10 cu. ft. double door refrigerator with icemaker and pantry
 High output three burner cook top with flush mount Corian® range cover
 GE® SpaceSaver convection microwave oven with carousel, built-in light and fan
 Systems monitor panel
 Cable TV hook-up and multiple telephone jacks
 Wall mounted AM/FM stereo with CD, clock, alarm and inside temperature monitor in bedroom
 Winegard® TV antenna

FURNITURE

Kustom Fit® fabric 6-way power driver recliner seat with swivel base and integrated seatbelt
 Kustom Fit® fabric passenger recliner seat with swivel base and integrated seatbelt
 Kustom Fit® 74" Wonder-Bed® sleeper sofa with slide-in armrests and drawer underneath
 Freestanding Kustom Fit® fabric swivel recliner chair with footrest

INTERIORS

Throughout Coach

Maple paneling and doors
 Solid wood raised panel cabinet doors and face framing
 Deluxe overhead storage doors with telestrut hardware; positive catches on all other doors
 Drawers with ball bearing roller guide design

Cockpit Area

Floormats

Living Area

Patterned plush carpet with deluxe pad
 Pleated day/night shades
 Valances and lambrequins
 Magazine rack
 Freestanding dinette table with two low-back wooden chairs (M374 and M391)
 Booth dinette with slide-out storage drawers (M375 and M395)

Kitchen Area

Corian® kitchen countertop with Corian® sink cover
 Slide-out pantry
 Wastebasket
 Silverware organizer
 Ceramic tile floor
 Venetian blind and valance

Bath Area

Ceramic tile floor
 Corian® edged bathroom lavatory
 Raised panel doors
 Insulated skylight in shower
 Towel bars
 Medicine cabinet
 Window in private toilet room
 Residential style pocket doors
 Residential toilet room door with hardware

Bedroom Area

Patterned plush carpet with deluxe pad
 Venetian mini-blinds
 Valances and lambrequins
 Raised panel doors
 "Sandpiper Deluxe" residential-style pillow top mattress
 Queen bed slide-out
 Coordinate bedspread, pillows and shams
 Radius padded headboard
 Nightstands with Corian® edged tops
 Cedar lining in wardrobe
 Rear wardrobe with mirrored sliding doors

Wall dresser with drawers and laundry hamper
 Residential style closet rods

ELECTRICAL SYSTEMS & LIGHTS

50 Amp 120V distribution panel and cord
 50 Amp shore power cord
 Dual 10 watt solar panels
 Onan® 6.5 kW LP generator
 2,000 watt inverter/converter with remote on/off switch
 Four 6V deep cycle house batteries
 Slide-out battery tray
 Two 760 CCA 12V maintenance-free chassis batteries
 Battery disconnect switch
 Porch light
 Patio receptacle
 Three water pump switches (kitchen, bath and service station)
 Decorative overhead dining light
 Cosmetic light in bathroom
 Decorative lights in living area
 Courtesy light at entry-door switch panel
 Fluorescent lights in ceiling

PLUMBING & LPG SYSTEMS

Coach Exterior

Heated and insulated holding and water tanks
 Manual dump valves
 Pressurized water fill with regulator
 Variable rate water pump
 Water heater by-pass valve
 Winterization antifreeze inlet to pump
 Holding tank rinsing system (waste tank only)
 Outside shower

Kitchen Area

Water filter in kitchen
 10 gallon gas/electric water heater
 Delta® single lever faucet with side sprayer

Bedroom/Bathroom Area

Porcelain toilet with sprayer
 Clear glass shower enclosure with etched decorative design for privacy
 One piece fiberglass tub and shower
 Single lever brass faucet with crystal handle
 Pre-plumbed for washer/dryer

SAFETY FEATURES

Fire extinguisher
 Deadbolt lock on entrance door
 12V GFI protected circuits (kitchen, bath and exterior)
 Smoke, carbon monoxide (CO) and LPG detectors
 Driver and passenger integrated three point lap and shoulder seatbelts
 Egress window
 Deluxe acrylic exterior assist handle

WINDOWS, DOORS & AWNINGS

Tinted dual pane windows
 Power double entrance step with light and anti-skid

Tinted skylight in bathroom
 Manual patio awning with metal cover*
 Slide-out topper awnings on living room, galley slide and bedroom slide*

VENTILATION

Dual 13,500 BTU Duo-Therm® low profile Penguin® air conditioners with in-ceiling ducting
 35,000 BTU furnace
 12V fan in bathroom
 12V Fan-Tastic® Vent with wall thermostat and rain sensor in living area

OPTIONAL FEATURES

Exterior

Upgraded custom painted two color exterior graphics with choice of two color packages (includes painted to match power controlled heated exterior mirrors)
 Manual front entry door awning*
 Manual living room and bedroom window awning package
 Onan® 7.5 kW Quiet Diesel generator
 Dual 13,500 BTU Duo-Therm® low profile Penguin® air conditioners with heat pumps, two-speed fans and in-ceiling ducting

Throughout Coach

Walnut paneling and doors

Cockpit Area

Pioneer® multi-disc CD changer
 RCA® DVD player
 Kingdome® automatic stationary satellite dish
 Roof mounted dual chrome trumpet air horns

Furniture

Kustom Fit® leather 6-way power driver recliner seat with swivel base and integrated seatbelt and Kustom Fit® leather passenger recliner seat with swivel base and integrated seatbelt
 Kustom Fit® leather 6-way power driver recliner seat with swivel base and integrated seatbelt and Kustom Fit® leather extra-wide passenger recliner seat with swivel base and integrated seatbelt
 Kustom Fit® 74" leather Wonder-Bed® sleeper sofa with slide-in armrests and drawer underneath
 Freestanding Kustom Fit® leather swivel recliner chair with footrest
 Booth dinette with slide-out storage drawers (M374 and M391)

Living Area

Two wooden folding dining chairs
 Freestanding dinette table with two low-back wooden chairs (M375 and M395)
 Booth dinette with slide-out storage drawers (M374 and M391)

Kitchen Area

21" high output three burner range and oven
 12 cu. ft. side-by-side refrigerator with ice maker (delete slide-out pantry)

Bedroom/Bathroom Area

Combination washer/dryer

WEIGHTS (POUNDS)	M374	M375	M391	M395
Spartan GTI				
Gross Vehicle Weight Rating	27,400 lbs.	27,400 lbs.	27,400 lbs.	27,400 lbs.
Gross Combined Weight Rating	32,400 lbs.	32,400 lbs.	32,400 lbs.	32,400 lbs.
Front Gross Axle Weight Rating	10,410 lbs.	10,410 lbs.	10,410 lbs.	10,410 lbs.
Rear Gross Axle Weight Rating	17,000 lbs.	17,000 lbs.	17,000 lbs.	17,000 lbs.
Unloaded Vehicle Weight	23,180 lbs.	23,530 lbs.	22,600 lbs.	23,960 lbs.
Maximum Carrying Capacity	4,220 lbs.	3,870 lbs.	4,800 lbs.	3,440 lbs.
Cargo Carrying Capacity	2,484 lbs.	2,134 lbs.	3,064 lbs.	1,704 lbs.
MEASUREMENTS	M374	M375	M391	M395
Wheelbase	228"	228"	252"	252"
Overall Length	37' 1"	37' 1"	39' 1"	39' 1"
Exterior Height (Road Height)	12' 2"	12' 2"	12' 2"	12' 2"
Exterior Height (with Satellite)	12' 8"	12' 8"	12' 8"	12' 8"
Interior Height	79 1/2"	79 1/2"	79 1/2"	79 1/2"
Interior Width	98"	98"	98"	98"
Exterior Width	102"	102"	102"	102"
TANK CAPACITIES	M374	M375	M391	M395
Water Heater	10 gal.	10 gal.	10 gal.	10 gal.
Gray Tank	40 gal.	40 gal.	40 gal.	40 gal.
Black Tank	45 gal.	45 gal.	45 gal.	45 gal.
Fresh Water Tank(s)	95 gal.	95 gal.	95 gal.	95 gal.
LPG Tank (Volume W.C.)	69 gal.	69 gal.	69 gal.	69 gal.

*Not available on CSA units

For more of everything
National RV Inc. related
join us at NRVCLUB.com



National RV Club (NRVC) is not affiliated with any other club or organization.
NRVC has no relationship with the defunct National R.V. Inc. or National R.V. Holdings.
NRVC has no relationship with REV Group, REV Recreation Group, or their motor home brands.