



SEA BREEZE

Motorhomes



Excellence From Every Angle

Since 1963, National RV has earned a well deserved reputation for quality, innovation, and outstanding value. One of the main reasons stands before you - our newest Sea Breeze.

Review the specifications list, and you'll soon see that this exceptional low-profile motorhome leads on standard equipment, spaciousness, storage, liquid capacities, and much more. Best of all, its excellence is easily within reach. Surprisingly, the richly appointed Sea Breeze handily beats the competition when it comes to price as well as features.

Year after year, National RV sets the industry standards. Case in point: Sea Breeze proves that generous storage and handsome exteriors can coexist in complete harmony. Instead of building another box on wheels, we've created a stylish RV with highline sculptured fiberglass skirting and refreshing new exterior graphics.

Look it over. Swing open one of the insulated compartment doors to review the most generous basement storage capacity in its category. Note that compartments are framed in rustproof galvanized steel for enduring performance. Inside the coach, there's plenty of extra storage and drawer space, plus a huge pantry. And with all it holds, Sea Breeze has a lower overall

height than most of its competition.

Of course, excellence is always reflected in the details. That's why you'll welcome such amenities as ducted roof air conditioning, directed by the Intellitec Dual Air System, an effective energy management system that runs both air conditioners on 30 amp service. Topping off each coach is a

leak-proof, thoroughly insulated rubber roof for your long term comfort. Additional standard features include sound-dampening Ozite ceilings that replace the vinyl ordinarily employed on competitive models. A close inspection of the galley reveals mortise-fit drawers running on ball bearing roller guides for smooth, trouble-free operation.

For entertaining and your personal viewing pleasure, each Sea Breeze comes with a 19" in-dash TV, while the bedroom is conveniently pre-wired for another TV. With over three decades of catering to RV enthusiasts, we know how to make your travelling experiences most enjoyable. Dump valves, for instance, are sensibly located so you won't have to crawl around to reach them. Another nice touch is an outside shower adjacent to the holding tank drain so you can hose everything down after dumping the tanks, or wash off those dirty little feet before entering the coach.

What more could you ask for? Chances are, we've already built it in. Experience Sea Breeze excellence firsthand at a dealer near you. Six exciting floor plans in lengths of 29', 31' and 33' await your closest inspection.



SUPERIOR CO



Chassis construction incorporates a heavy gauge galvanized sub floor installed directly on the frame. Wood is never used!



Our roofs have more steel cross members than most competitors with 24" to 30" centers compared to 36" to 48" for others.



State-of-the-art fiberglass manufacturing holds to tight tolerances and achieves the highest levels of quality.



Extensive undercoating is applied to each unit to provide properly sealed compartments and to enhance sound deadening.

CONSTRUCTION



After being aligned on the most advanced electronic equipment, every National RV motor-home is road tested for ride and handling.



Custom designed furniture receives its finishing touches in our factory to guarantee high levels of quality and comfort.



National RV's modern facilities are designed for smooth, error-free automated production every step of the way.



Each unit is thoroughly rain-tested before delivery. This important step helps assure a water-tight motorhome.

FLOOR PLANS



Model SB129

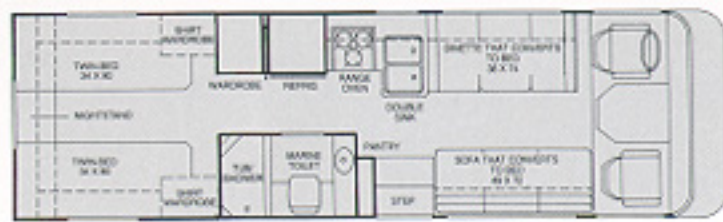

Model SB129-T



Model SB131



Model SB131-T



Model SB133



Model SB133-T

Due to continual product improvement, we reserve the right to change materials, colors, specifications, and prices at any time, with out notification. Effective 10/95 production.

SPECIFICATIONS

VEHICULAR DRIVING AREA

- Chevrolet 454 CID-7.4 Liter V-8 EFI
- Ford 460 CID-7.5 Liter V-8 EFI
- Engine Oil Cooler
- Transmission Oil Cooler
- Overdrive Automatic Transmission
- Power Steering/Brakes
- Electric Fuel Pump
- Auxiliary Start System
- Alternator - 130 Amp Ford
105 Amp Chevrolet
- Radial Tires (7)
- Tilt Steering Wheel
- Cruise Control
- In-Dash Heat and Air Conditioning
- Full Panoramic Wrap-Around Tinted
Windshield
- Panoramic Windshield Wipers
w/Intermittent Speed Control
- Map Light
- Cigarette Lighter
- Reclining Bucket Seats w/Swivel
- Acrylic Sun Visors
- AM/FM Auto Reverse Stereo Cassette
- Wheel Covers
- Deluxe Exterior Mirrors w/ Convex

EXTERIOR FEATURES

- Full Fiberglass Front Cap
- Mende Board Side Walls
- Insulated Fiberglass Baggage Doors
- Rubber Roof
- Brushed Stainless Steel Front Bumper
- Radius Windows
- Sliders in Living Room
- Jalousie in Bedroom/Galley
- Tinted Windows w/Screens
- Awning Rail
- Dead Bolt Lock
- City Water Hook Up
- Lighted Cargo Bins
- Outside Porch Light
- Entry Assist Handle
- Radius Entrance Door
- Insulated Cargo Bin Floors
- Outside Shower

INTERIOR FEATURES

- Oak Framed Raised Panel Cabinet Doors
- Decorative Mirrored Doors in Lounge &
Bedroom
- Oak Trim Throughout
- Deluxe Highline Carpet and Pad
Throughout
- Vinyl Floor in Bath and Galley
- Pantry
- Sliding Privacy Door
- Built-In Trash Can
- Oak Drawer Fronts
- Custom Designed Interior Decors of
Woven Jacquard Olefin
- Color Coordinated Mini Blinds
w/Designer Valances
- Fabric Ceiling
- Color Coordinated Bedspread, Shams &
Pillows
- Beveled Dressing Mirror
- One-Piece Molded Fiberglass Shower
- Sky light in Shower
- Double Sink in Galley
- Fire Extinguisher
- Padded Dinette End Caps
- Ceiling Vents
- Sink Cover

APPLIANCES & ELECTRICAL

- Double Door Dometic Refrigerator
(LP/110V)
- 19" TV w/ Remote
- TV Antenna
- Coffee Maker
- LP/CO/Smoke Detectors
- 110 Amp Deep Cycle House Battery
- GFI Protected Electrical Circuit
- 120V/12V Power Conv./Charger - 50
Amp
- 3-Burner Cook Top
- Power Range Hood w/ Light
- Demand Water Pump
- Systems Monitor Panel to Measure
Tanks, Battery and Propane
- 110V Receptacles
- Adjustable Reading Lamps
- Power Vent in Bath
- Wired & Const. for Ducted Roof Air

- Cable TV Hookup
- 35,000 BTU Ducted Furnace
- 6 Gallon Fast Recovery Water Heater

OPTIONS

- 5.5 KW Generator
- Central Air - Duotherm
(129 & 131) 15,000 BTU
(131 & 133) 13.5 & 13.5 BTU
- Microwave Oven (900 Watt)
- 6 Gallon DSI Hot Water Heater
- Class III Trailer Hitch
- Dash Fans
- Power Entrance Step
- LP Gas Oven
- 13" TV in Bedroom w/Remote
- Roof Rack and Ladder
- VCR / Antenna Selector
- Wood Plank Floor in Galley

- Convection Microwave
- Drink Tray
- Twin Beds
- Awning-A&E 9000
- Power Heated Mirrors
- Wheel Liners-S/S
- Front Overload Spring
(Chevrolet 133 Only)
- Electric Horns-Roof Mount
- Privacy Decal - 133 Shower
- Folding Stove Cover
- 8' Refrigerator-Dometic
- Second House Battery
- Hydraulic Jacks + Kwikkee
- Weather Package (Dual Batteries, Battery
Disconnect, Holding Tank Heaters)
- Limited Package (Models 131/133)
- Thermopane Windows
- 2 Chairs & Table (Model 129)

WEIGHTS/CAPACITIES

DIMENSIONS	SB129	SB131	SB133
Overall Length	29' 3"	31' 4"	33' 0"
Overall Height (Ford)	N/A	11' 1"	11' 1"
Overall Height (Chev)	11' 0"	11' 0"	11' 0"
Overall Width	8' 0"	8' 0"	8' 0"
Interior Height	6' 4"	6' 4"	6' 4"
Interior Width	7' 8.5"	7' 8.5"	7' 8.5"
CAPACITIES (Gallons)	SB129	SB131	SB133
Fresh Water	65	65	65
Hot Water	6	6	6
Waste Water Holding Tank	32.6	38	38
Gray Water Holding Tank	32.6	38	38
LP Gas Capacity	24	24	24
CHASSIS	SB129	SB131	SB133
CHEVROLET			
Wheel Base	190"	208"	228"
Fuel Capacity - Gal.	80	80	80
GVWR - lbs.	14,800	16,500	16,500
UVW (Weight Unloaded) -lbs.*	11,880	12,640	12,700
NCC (Net Cargo Capacity) - lbs.**	2,920	3,860	3,800
FORD (Option)			
Wheel Base	N/A	208"	228"
Fuel Capacity - Gal.	N/A	75	75
GVWR - lbs.	N/A	17,000	17,000
Weight Unloaded -lbs.	N/A	12,810	13,440
Payload - lbs.	N/A	4,190	3,560

*UVW: (Unloaded vehicle weight) Curb weight including fuel. **NCC: Net Cargo Capacity for water, LPG, passengers and cargo.



Come In and Make Yourself at Home

National RV's unsurpassed quality and extensive array of standard features contribute greatly to your travelling pleasure. The expansive windshield brings the panorama of outdoor vistas inside when you've stopped for the night. Stretch out in your spacious master suite, replete with an island queen bed, plus loads

In Dash T.V.

As standard, a 19" remote-control color TV is mounted in the dash for convenient viewing.



of storage space that includes wardrobes in the dressing areas.

You'll appreciate National RV's extensive amenities throughout each of our well organized floor plans. For instance, there's an inviting L-shaped galley in Model SB129. Like all Sea Breeze motorhomes, it features solid oak drawer fronts. For light and privacy control, color-coordinated interiors in Model SB129 have popular mini-blinds, while Limited Edition units include both day/night shades and mini-blinds.

Elegant Garden Bath

This large garden bath is an exclusive highlight of Model SB133. There's a beautiful glass enclosed garden shower and lavatory on one side of the hall and the toilet on the other. Goldtone fixtures and trim provide elegant accents, while a domed skylight contributes to the overall lighting and spacious feeling.



San Simeon



West Port

Exquisite Fabrics impart an inviting designer touch to every Sea Breeze Model.





Limited Edition's Galley
Complete food preparation facilities, expansive storage, and easy care have long been exceptional Sea Breeze strengths. Complementing the beauty of our galley's traditionally popular raised panel cabinetry, is a clever new folding Corian counter top that conceals the range when not in use. Handsome oak trim is utilized throughout.



Emerald Bay



Vista Del Sol



Pacific Grove

Add elegance and style with appealing fabrics in your choice of color schemes.

Our Finest: Sea Breeze Limited Edition

Every Sea Breeze is sensational. In these luxury versions, they're truly remarkable! The exciting Limited Edition package adds a wealth of special features for enhanced comfort, convenience and luxury.

National RV's decorating team had a free hand to custom-design these interiors. You're sure to delight in the results, which employ handsome woven Jacquard Olefin fabrics, deluxe carpeting, raised panel hardwood cabinet doors, and

day/night shades with designer valance in the lounge area.

This prestigious package also includes a flush-mounted Corian counter top in the galley, deluxe fiberglass spare tire cover, a second coach battery, single-lever galley faucet, power heated mirrors, electric horn, heated holding tanks and a battery disconnect switch. In addition, you can choose from a host of unique options that are available only to Luxury Edition owners.

DEALER



24-Hour Toll-Free Help Line

As an original Sea Breeze owner, you can call toll-free, anytime, for expert advice on any problem you might have. (Good for one year from date of purchase. Non-transferable program can be extended for a nominal fee.)



Sea Breeze

National R.V., Inc.

3411 N. Perris Blvd., Perris CA 92571 • 909-943-6007

© Copyright 1996 National R.V., Inc. 11/95 70M

For more of everything
National RV Inc. related
join us at NRVCLUB.com



National RV Club (NRVC) is not affiliated with any other club or organization.
NRVC has no relationship with the defunct National R.V. Inc. or National R.V. Holdings.
NRVC has no relationship with REV Group, REV Recreation Group, or their motor home brands.