

# Sea Breeze

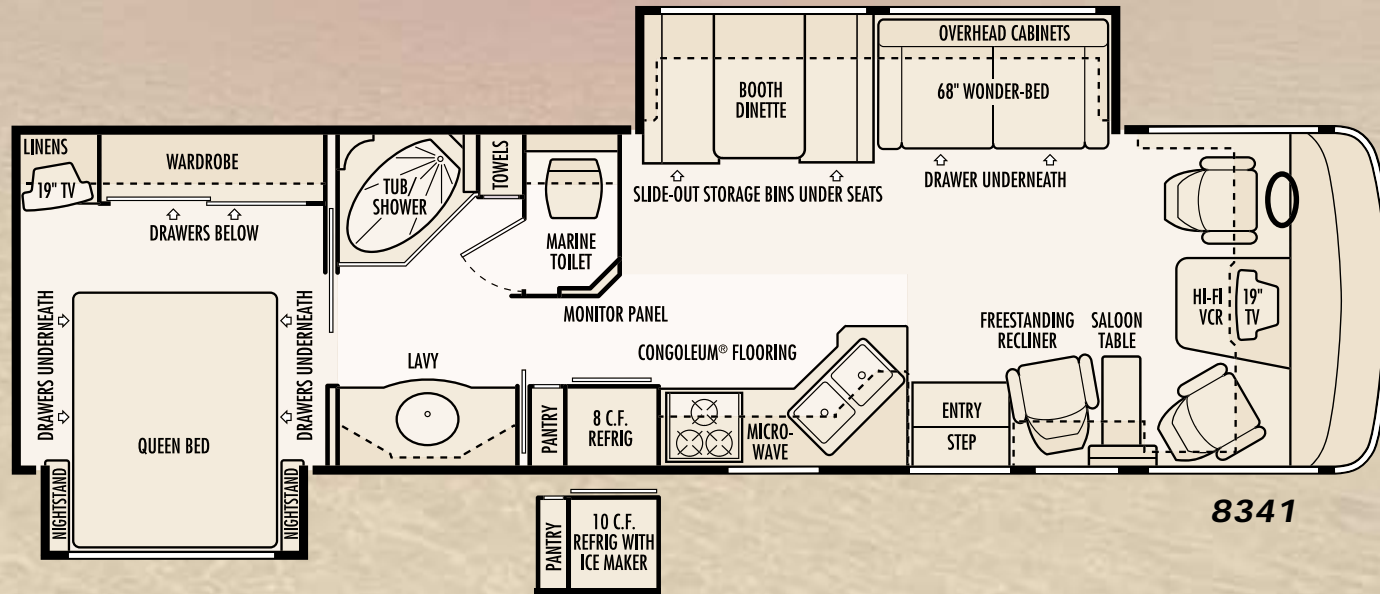
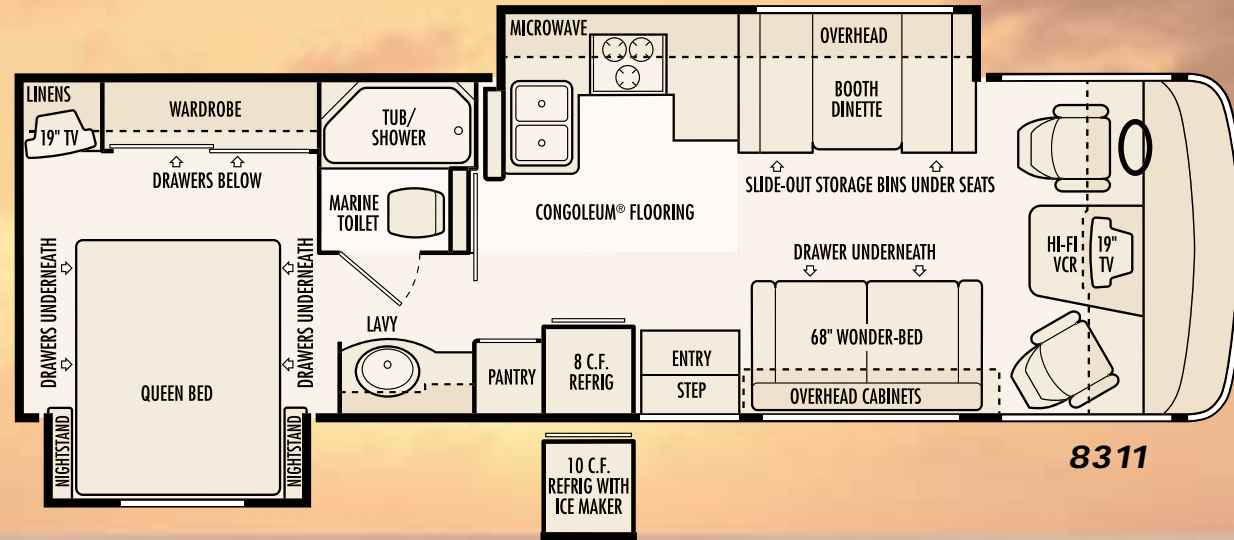

Due to continued product improvement, National R. V., Inc. reserves the right to change materials, colors, specifications and prices at any time without notification. Copyright © 2002 by National R. V., Inc. 07/02

# SEA BREEZE LX FEATURES & SPECIFICATIONS

CHASSIS SPECIFICATIONS		FORD
<b>Chassis</b>	Ford® Super Duty (22,000 GVWR)	
<b>Tires</b>	Goodyear® RV 245/70R 19.5F	
<b>Wheels</b>	19.5X6, 8-Lug Steel, SS Liner	
<b>Brakes</b>	Hydro-Boost, 4-Wheel Disc ABS	
<b>Drive Axle gear Ratio</b>	5.38:1	
<b>Alternator</b>	115 Amp	
<b>Chassis Batteries</b>	(1) 750 CCA	
<b>Shock Absorbers</b>	Ford® Factory Installed Shock Absorbers	
<b>Fuel Capacity</b>	75 gallon	
<b>Hitch Capacity</b>	5,000 lbs. Class III	
<b>Chassis Warranty</b>	3 years/36,000 miles	
<b>Engine</b>	Ford® Triton V-10	
<b>Displacement</b>	6.8 Liters (415 cu. in.)	
<b>Peak Horsepower</b>	310 HP @ 4,250 RPM	
<b>Peak Torque</b>	425 ft./lbs. @ 3,250 RPM	
<b>Engine Warranty</b>	3 years/36,000 miles	
<b>Transmission</b>	Ford® 4R100	
<b>Transmission Type</b>	4-Speed Automatic Overdrive	
<b>Transmission Warranty</b>	3 years/36,000 miles	

## BODY CONSTRUCTION

Duraframe® patented steel sub floor construction  
 Steel framed laminated floor  
 Steel framed crowned laminated fiberglass roof  
 Steel framed laminated fiberglass high gloss walls  
 Front and rear molded fiberglass caps  
 High impact Centrex® front and rear bumpers  
 Full panoramic tinted windshield  
 Soft fabric ceiling material  
 Electric slide-out room with overhead cabinets  
 High impact Centrex® exterior storage compartment doors with integrated latches and gas struts  
 One-piece rotocast polyethylene storage compartments  
 Lighted storage compartments and service area  
 Exterior assist handle  
 Aluminum rear ladder  
 Awning rail/rain gutter with drip spouts  
 Automotive undercoating as required  
 Steel insulated front bulkhead  
 Custom vinyl exterior graphics

## COCKPIT FEATURES

JVC® AM/FM stereo and CD with four speakers  
 Driver and passenger gooseneck reading lights  
 Custom dash in gray matte diamond brush finish with full gauge package  
 Convenience tray  
 Audible turn signals  
 Pantographic windshield wipers  
 Power steering  
 Cruise control  
 Tilt steering wheel  
 Rear vision system with built-in microphone

Power heated rear view mirrors with double convex  
 Passenger work station with 12V/120V receptacle in console  
 Aviation style sun visors  
 Hydraulic leveling jacks with dash mounted controls  
 Generator hour meter and auxiliary start switch on dash  
 Wraparound privacy curtain with easy reach wand  
 CB radio ready

## APPLIANCES & ACCESSORIES

Multi-speaker TV sound  
 8 cu. ft. double door refrigerator  
 High output three burner cook top with flush mount Corian® range cover  
 Over-the-counter mount microwave with built-in range hood, lights and fan  
 Systems monitor panel  
 Cable TV hook-up and multiple telephone jacks  
 TV antenna  
 RCA® 19" TV with front A/V jacks in cockpit  
 RCA® Hi-Fi VCR in cockpit  
 RCA® 19" TV with front A/V jacks in bedroom  
 Video control box with antenna booster

## FURNITURE

Kustom Fit® fabric driver recliner seat with swivel base  
 Kustom Fit® fabric passenger recliner seat with swivel base  
 Kustom Fit® Wonder-Bed® fabric sleeper sofa with slide-in armrests and drawer underneath (74" for 8311; 68" for 8341)  
 Freestanding Kustom Fit® fabric swivel recliner chair with footrest (8341)

## INTERIORS

### Throughout Coach

Maple paneling and doors  
 Tealstrut hardware on overhead doors and positive catches on others  
 Drawers with ball bearing roller guide design

### Cockpit Area

Floormats

### Living Area

Booth dinette with slide-out storage drawers  
 Day/night shades with designer valances  
 Solid raised panel overhead cabinet doors and flat panel base cabinet doors

### Kitchen Area

Corian® kitchen countertop with Corian® flush mount stove cover (angled galley on 8341)  
 Porcelain sink with wood cutting block sink cover  
 Wastebasket  
 Armstrong® vinyl flooring  
 Venetian mini-blind with valance (8341)

### Bath Area

Armstrong® vinyl flooring  
 Decorative shower glass etching

Flat panel doors  
 Laminate lavy top with woodgrain edge  
 Medicine cabinet  
 Towel bars  
 Residential doorknob for toilet room door

## Bedroom Area

Deluxe nylon carpet and pad  
 Venetian mini-blinds with valances  
 Flat panel doors  
 Cedar lining in wardrobe  
 Wardrobe with mirrored sliding doors  
 Color coordinated bedspread, pillows and shams  
 Radius padded headboard  
 Slide-out queen bed with four pull out drawers and storage compartment  
 "Sandpiper Deluxe" residential-style pillow top mattress  
 Laminate top nightstands with woodgrain edge  
 Residential style closet rods

## ELECTRICAL SYSTEMS & LIGHTS

50 Amp MagneTek® power converter and charger  
 50 Amp 120V distribution panel and cord  
 Onan® Marquis Gold™ 5.5 kW generator  
 Two 6V deep cycle house batteries  
 Battery disconnect switch for house batteries  
 Porch light with interior switch  
 110V patio receptacle  
 Recessed fluorescent lights in ceiling  
 Designer lights in living and bedroom areas  
 Cosmetic light in bathroom  
 Two water pump switches (kitchen and bath)  
 GFI protected electrical circuit  
 Courtesy light at entry-door switch panel

## PLUMBING & LPG SYSTEMS

### Coach Exterior

Heated systems compartment with easy access to hook-ups  
 On demand water system and water pump  
 Holding tank rinse system (black tank only)  
 Manual dump valves  
 Winterization antifreeze inlet to pump  
 Outside shower  
 Water heater by-pass valve  
 Pressurized water fill  
 Six gallon LPG water heater with electric ignition (DSI)

### Kitchen Area

Delta® single lever chrome faucet with side sprayer

### Bath Area

One-piece fiberglass tub/shower  
 Residential single lever pressure balancing shower faucet with fixed head  
 Single lever brass faucet with crystal handle

## SAFETY FEATURES

Extra large double convex rear view mirrors

Driver and passenger three point lap and shoulder seatbelts  
 Deadbolt lock on entry door  
 Fire extinguisher  
 Smoke, carbon monoxide (CO) and LPG detectors  
 Egress window

## WINDOWS, DOORS & AWNINGS

Radius tinted safety glass windows (sliding windows in living area and jalousie windows in kitchen and bedroom)  
 Radius entrance door with clear glass, shade and screen door  
 Power double entrance step with light and anti-skid  
 Ventilated windows on sides of slide-out rooms (lounge slides only)  
 Slide-out rooms topper awnings\*  
 Tinted skylight in bathroom (8341)

## VENTILATION

Thermostatically controlled dual 13,500 BTU ducted roof A/Cs  
 35,000 BTU electronic ignition furnace  
 Ducted heating system  
 12V roof exhaust fan in bathroom  
 Dash automotive heating and A/C system with defroster

## OPTIONAL FEATURES

### Coach Exterior

Dual pane windows  
 Manual patio awning with metal cover\*

### Cockpit Area

Pioneer® AM/FM stereo with CD player, XM receiver and remote control  
 RCA® DVD player  
 JVC® multi-disc CD changer (for use with JVC® receiver)  
 Pioneer® multi-disc CD changer (for use with Pioneer® receiver)  
 400 watt inverter  
 Kingdome® automatic stationary satellite dish

### Living Area

Freestanding dinette table with four low-back wooden chairs (8341)

### Kitchen Area

10 cu. ft. double door refrigerator with icemaker (with pantry)  
 21" high output three-burner range with oven (surface mounted)  
 Corian® countertop extension  
 Convection microwave oven with carousel, built-in light and fan  
 Variable speed 12V Fan-Tastic® Vent

WEIGHTS (POUNDS)	8311	8341
<b>Ford Chassis</b>		
Gross Vehicle Weight Rating	22,000 lbs.	22,000 lbs.
Gross Combined Weight Rating	26,000 lbs.	26,000 lbs.
Front Gross Axle Weight Rating	7,000 lbs.	7,000 lbs.
Rear Gross Axle Weight Rating	15,000 lbs.	15,000 lbs.
Unloaded Vehicle Weight	15,840 lbs.	16,820 lbs.
Maximum Carrying Capacity	6,160 lbs.	5,200 lbs.
Cargo Carrying Capacity	4,851 lbs.	3,700 lbs.
<b>MEASUREMENTS</b>		
Wheelbase	208"	228"
Overall Length	31' 8"	34' 11"
Exterior Height (Road Height)	11' 9"	11' 9"
Exterior Height (with Satellite)	11' 11"	11' 11"
Interior Height	79½"	79½"
Interior Width	98½"	98½"
Exterior Width	102"	102"
<b>TANK CAPACITIES</b>		
Water Heater (Gas/Electric)	6 gal.	6 gal.
Gray Tank	40 gal.	50 gal.
Black Tank	40 gal.	50 gal.
Fresh Water Tank(s)	67 gal.	90 gal.
LPG Tank (Volume W.C.)	24.2 gal.	24.2 gal.

\*Not available on CSA units

For more of everything  
National RV Inc. related  
join us at [NRVCLUB.com](http://NRVCLUB.com)



National RV Club (NRVC) is not affiliated with any other club or organization.  
NRVC has no relationship with the defunct National R.V. Inc. or National R.V. Holdings.  
NRVC has no relationship with REV Group, REV Recreation Group, or their motor home brands.